

# CYRUS



Cyrus Pre-XR User guide for firmware version V1.0.1  
An updated user guide may be available from  
[www.cyrusaudio.com](http://www.cyrusaudio.com) for newer firmware revisions

---

**CONTENTS**

---

IMPORTANT! READ BEFORE OPERATING THIS EQUIPMENT! ...1	REMOTE CONTROL OPERATION .....13
Power supply .....2	Remote control introduction .....13
Servicing .....2	Remote control backlight .....13
Product service centres .....2	Fitting batteries to the remote control .....13
WELCOME TO THE WORLD OF CYRUS! .....3	Sending commands to Cyrus components .....13
Preparations for Installation .....3	Switching on Cyrus source components .....13
INSTALLATION .....4	Cyrus amplifier commands .....14
Key to the rear panel drawing .....4	Cyrus CD player commands .....15
Important – read before making any connections .....5	Cyrus audio streamer commands .....16
Connecting analogue audio sources .....5	Cyrus Phono Signature commands .....17
Connecting a turntable .....5	SETUP MENUS .....18
Digital audio inputs .....5	Setup options .....18
USB audio input .....5	Navigating the menu from the front panel .....18
Connecting a power amplifier/speakers .....6	Navigating the menu from the remote control .....18
Balanced connection .....6	Menu maps .....19
Unbalanced connection .....6	FIRMWARE UPDATES .....21
Connecting speakers .....6	REMOTE CONTROL LEARNING .....22
Connecting a power amplifier/speakers .....7	Preparation for learning .....22
Bi-amping .....7	Learning commands .....22
Connecting speakers .....7	Checking programmed commands .....23
Using the fixed output of your amplifier .....8	Problems with learning .....23
Connecting a tape recorder for recording .....8	Sending TV or SAT commands .....23
Connecting a second amplifier .....8	TROUBLESHOOTING GUIDE .....24
Connecting headphones .....8	Error indication .....24
Connecting a Cyrus surround sound decoder .....8	SPECIFICATIONS .....25
Connecting a surround sound decoder (other brand) .....8	Power Supply .....25
MC-BUS system .....9	Power Consumption .....25
External power supply - PSU-XR .....9	Enclosure .....25
How it works .....9	Analogue audio performance .....25
Connecting to the AC mains supply .....9	Digital audio performance .....25
OPERATION .....10	WARRANTY .....25
Key to the front panel drawing .....10	WEEE .....25
Touch pad controls .....10	
Power .....10	
Mains power .....10	
Standby .....10	
Auto-standby .....10	
Selecting an input .....10	
Input source type ‘Cyrus AV’ or ‘AV’ .....10	
Playing DSD audio from a computer .....11	
Volume level .....11	
Volume .....11	
Headphone volume .....11	
Safe volume levels after standby .....11	
Balance .....11	
Mute .....11	
Headphones .....11	
Filter .....11	
Tape playback and recording .....12	
Playback .....12	
Recording .....12	
Playing through a second amplifier .....12	

---

**IMPORTANT! Read before operating this equipment!**

**CAUTION:** The exclamation mark is to draw your attention to important instructions and safety procedures in this manual.



**ATTENTION:** The lightning flash warns you of the risk of electrical shock presented by components inside this product. Unauthorised personnel must not open this unit.



**WARNING:** To reduce the risk of electrical shock do not remove any unit covers or panels. There are no user serviceable parts in this product.

**WARNING:** To reduce the risk of electric shock, do not expose this equipment to rain or moisture.

**HEED WARNINGS:** All warnings on the product and in the operating instructions should be adhered to.

**READ ALL THE INSTRUCTIONS:** All the safety and operating instructions should be read before the product is operated.

**RETAIN INSTRUCTIONS:** The safety and operating instructions should be retained for future reference.

**FOLLOW INSTRUCTIONS:** All operating and use instructions should be followed.

**CLEANING:** Unplug this product from the mains before cleaning. Do not use liquid or aerosol cleaners. Use a damp cloth for cleaning.

**WATER AND MOISTURE:** Do not use this product near water - for example, near a bath tub, wash bowl, kitchen sink, or laundry tub, in a wet basement; or near a swimming pool and the like. The product must not be exposed to dripping or splashing and no objects filled with liquids, such as vases, shall be placed on the product.

**HEAT:** The product should be situated away from heat sources such as radiators, stoves, or any other products (including amplifiers) that produce heat.

**VENTILATION:** Slots and openings in the cabinet are provided for ventilation, to ensure reliable operation of the product and to protect it from overheating and these openings must not be blocked or covered. The openings should never be blocked by placing the product on a bed, sofa, rug or similar surface. This product should not be placed in a built-in installation such as a bookcase or rack unless proper ventilation is provided or the manufacturer's instructions have been adhered to.

**OBJECT OR LIQUID ENTRY:** Never push objects of any kind into this product through openings as they may touch dangerous voltage points or short-out parts that could result in a fire or electric shock.

**ACCESSORIES:** Do not place this product on an unstable cart, stand, tripod, bracket, or table. The product may fall, causing serious injury to a child or adult, and serious damage to the product. Use only with a cart, stand, tripod, bracket or table recommended by the manufacturer, or sold with the product. Any mounting of the product should follow the manufacturer's instructions, and should use a mounting accessory recommended by the manufacturer.

**ATTACHMENTS:** Do not use attachments not recommended by the product manufacturer as they may cause hazards.

**MOVING THE PRODUCT:** A product and cart combination should be moved with care. Sudden stops, excessive force, and uneven surfaces may cause the product and cart to overturn.



**POWER SOURCES:** This product should be operated only from the type of power source indicated on the marking label. If you are not sure of the type of power supply to your home, consult your product dealer or local power company. For products intended to operate from battery power, or other sources, refer to the operating instructions.

**OVERLOADING:** Never overload wall outlets, extension cords, or integral convenience receptacles. This can result in an increased risk of fire or electric shock.

**POWER CORD PROTECTION:** Power supply cords should be routed so that they are not likely to be walked on or pinched by items placed upon or against them, paying particular attention to cords at plugs, convenience receptacles, and the point where they exit from the product.

**NAKED FLAMES:** No naked flame sources, such as candles, must be placed on this product.

**LIGHTNING:** For added protection for this product during a lightning storm, or when it is left unattended or unused for long periods of time, unplug it from the wall outlet and disconnect the antenna or cable system. This will prevent damage to the product due to lightning and power-line surges.

**BATTERIES:** Warning: Batteries shall not be exposed to excessive heat such as sunshine, fire or the like.

**CAUTION! POLARISED CONNECTOR (CANADA and USA):**

To prevent electrical shock, match wide blade of plug to wide slot, fully insert. Do not alter or remove this plug if it does not fit your mains power socket. Have a suitable socket installed by a competent electrician.

**ACCESS TO THE MAINS PLUG:** The means to disconnect this product from the mains supply is the mains plug. Ensure that the mains plug is accessible at all times.

### Power supply

---

Connect the moulded IEC connector of the supplied AC cord into the power inlet on the rear of the unit.

The mains supply requirement of your amplifier is marked on a label on the rear panel. Before connecting, check that this voltage is the same as your mains supply.

220-230V Products: Voltage Range 220V-240V

115V Products: Voltage Range 110V-120V

If you move to an area with a different mains voltage, contact your local Cyrus distributor to have your product converted.

There are no user replaceable fuses in this unit.

### Servicing

---

Do not attempt to service this product yourself as opening or removing covers may expose you to dangerous voltage or other hazards. Refer all servicing to qualified service personnel.

**CONDITIONS REQUIRING SERVICE:** Unplug this product from the wall outlet and refer servicing to qualified service personnel when:

- When the power supply cord or plug is damaged.
- If liquid has been spilled, or objects have fallen into the product.
- If the product has been exposed to rain or water.
- If the product has been dropped or damaged in any way.
- If the product does not operate normally by following the operating instructions. (Adjust only those controls that are covered by the operating instructions. Improper adjustment of other controls may result in damage requiring extensive work by a qualified technician to restore the product to its normal operation).
- When the product exhibits a distinct change in performance.

**REPLACEMENT PARTS:** When replacement parts are required, be sure the service technician has used replacements specified by the manufacturer or have the same characteristics as the original part. Unauthorised substitutions may result in fire, electric shock, or other hazards.

**SAFETY CHECK:** Upon completion of any service or repairs to this product, ask the service technician to perform safety checks to determine that the product is in proper operating condition.

### Product service centres

---

For product service or technical advice, contact only authorised Cyrus service centres. Contact details for Cyrus distributors may be found on the Cyrus website at [www.cyrusaudio.com](http://www.cyrusaudio.com).

**Welcome to the world of Cyrus!**

Congratulations on your choice of Cyrus Hi-fi products. Our state-of-the-art design technology and outstanding quality of manufacture has won countless awards around the world. We are confident that you will derive great pleasure from owning a product from one of the most recognised and respected manufacturers of hi-fi equipment.

Now is a good time to register your new Cyrus product. To register, visit [www.cyrusaudio.com/support](http://www.cyrusaudio.com/support) and click the 'Register your product' link.

Please read these instructions carefully before commencing installation. They provide full guidance to help you install your amplifier safely and correctly.

**Preparations for Installation**

Before installing your Cyrus amplifier check that the following items are included in the accessory box.

- Power Cable
- Remote Handset
- 4 Loudspeaker Plugs

After removing these items, please retain the packaging.

Install the amplifier in a well ventilated location away from sources of high temperature, dust or humidity. Never stand the amplifier under another unit or on any surface likely to obstruct its cooling or ventilation.

## Installation

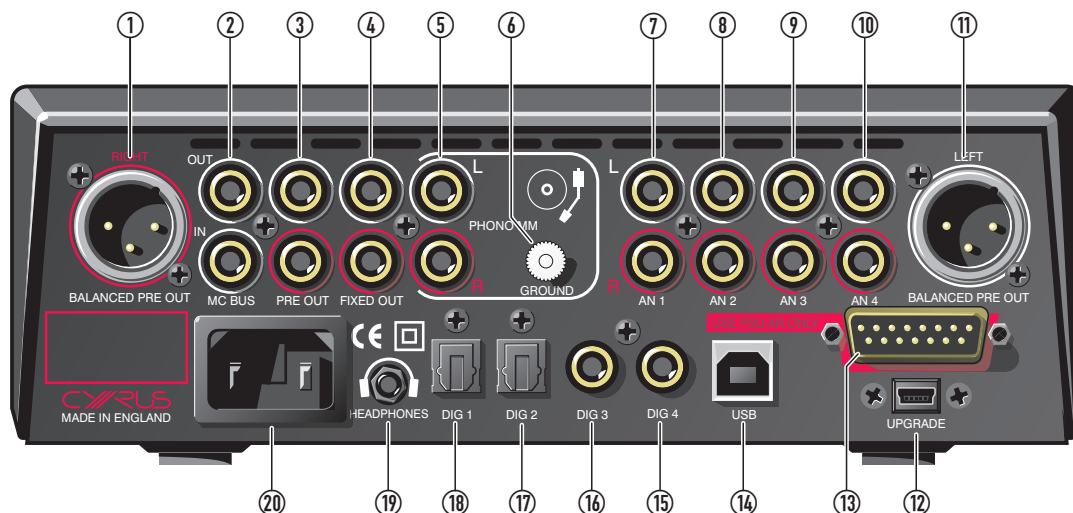

### Key to the rear panel drawing

- |                             |                          |                          |
|-----------------------------|--------------------------|--------------------------|
| 1. Right balanced output    | 8. AN2 analogue input 2  | 15. DIG4 digital input 4 |
| 2. MC-BUS system connection | 9. AN3 analogue input 3  | 16. DIG3 digital input 3 |
| 3. Pre-amplifier output     | 10. AN4 analogue input 4 | 17. DIG2 digital input 2 |
| 4. Fixed output             | 11. Left balanced output | 18. DIG1 digital input 1 |
| 5. Phono/MM input           | 12. Upgrade port         | 19. Headphone socket     |
| 6. Phono ground terminal    | 13. PSU-XR connection    | 20. Power inlet          |
| 7. AN1 analogue input 1     | 14. USB input            |                          |

**Important – read before making any connections**

To avoid possible damage to your audio system, it is essential to disconnect all system components from the mains supply before connecting or disconnecting audio interconnects.

**Connecting analogue audio sources**

- Connect a stereo audio interconnect cable between each analogue source component and one of the analogue input sockets 'AN1 - AN4'.

*Ensure left and right channels are correctly connected.*

*Make a note of the input number used for each source as the inputs can be re-named at the set-up stage.*

The analogue inputs are compatible with the connection of stereo analogue audio sources. These include-

*Analogue output from CD/Blu-ray Players*

*Analogue output from DAB or FM radio tuners*

*Analogue output from a TV*

*Analogue tape recorders*

*Cyrus surround decoder*

**Connecting a turntable**

The PHONO/MM input is compatible with turntables fitted with moving-magnet cartridges. The turntable will have a cable with two plugs, and often a thin ground wire with a tag.

- Connect the plugs to the 'PHONO/MM' sockets on the back panel. Connect the white plug to the left socket and the red plug to the right socket.
- Unscrew the 'GROUND' terminal then fasten the ground wire (where fitted) under the terminal.

**Digital audio inputs**

- Using a suitable Toslink optical or digital phono interconnect, connect each digital audio source to one of the inputs 'DIG1 - DIG4'.

*Make a note of the input number used for each source as the inputs can be re-named at the set-up stage.*

The digital audio inputs are compatible with a number of different digital audio sources. These include-

*Digital audio output from a CD player*

*Digital audio output from a TV*

*Digital audio output from a games console*

*Digital radio*

*Blu-ray players*

*Digital satellite receivers*

*Digital tape/disc recorders*

*NOTE: The digital audio inputs are only compatible with 2 channel PCM source material and will not reproduce multi-channel surround sound.*

**USB audio input**

The USB audio input may be used to connect the audio feed from a Windows PC or Apple computer.

With a USB connection in place, DSD audio files can also be played.

- Connect a cable from a USB outlet of the computer to the 'USB B' input.

**Connecting a power amplifier/speakers**

The Pre-XR requires an external power amplifier to drive the system loudspeakers. Two types of connection are provided for power amplifiers - balanced via XLR connectors and unbalanced via phono connectors. Either or both connections can be used.

If your power amplifier has balanced inputs, these are preferred for the best quality.

**Balanced connection**

Balanced connection is shown in the example diagram below with dual mono power amplifiers and bi-wired speaker connection.

- Connect a balanced XLR interconnect from the 'BALANCED PRE OUT' sockets to the balanced inputs of the power amplifier.

*Ensure left and right channels are correctly connected.*

**Unbalanced connection**

- Connect a phono interconnect from the 'PRE OUT' sockets to the unbalanced inputs of the power amplifier.

*Ensure left and right channels are correctly connected.*

**Connecting speakers**

The speakers will connect to the power amplifiers. Refer to the power amplifier handbook for instructions to connect the speakers.

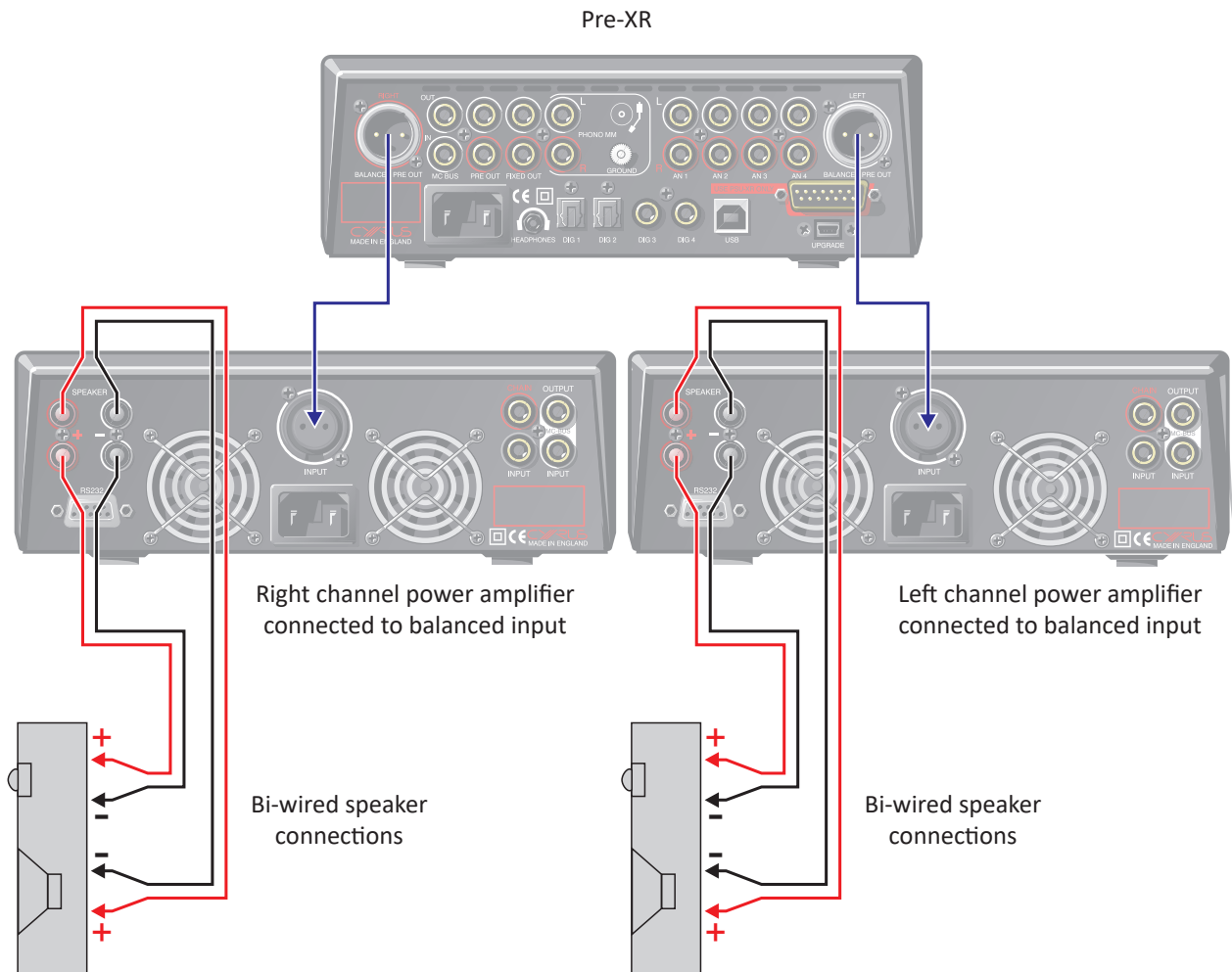



**Connecting a power amplifier/speakers**

**Bi-amping**

The pre-amplifier output may be used in conjunction with additional power amplifier(s) to significantly upgrade your loudspeaker system through Bi-amping.

The Cyrus range of power amplifiers is recommended for this application as they will have the correct matching gain. Both stereo and high power monobloc Cyrus power amplifiers are available to partner your amplifier.

NOTE: A bi-amp system can only be set up with speakers that have bi-wire connections (separate bass and treble connections).

CAUTION: Ensure that any bi-wire or bridging links are removed from the speaker terminals before connecting up a bi-amped system.

Refer to the wiring plan of a bi-amplified system below. Take care to connect each of the amplifier output channels to the correct power amplifier and loudspeaker.

**Connecting speakers**

The speakers will connect to the power amplifiers. Refer to the power amplifier handbook for instructions to connect the speakers.

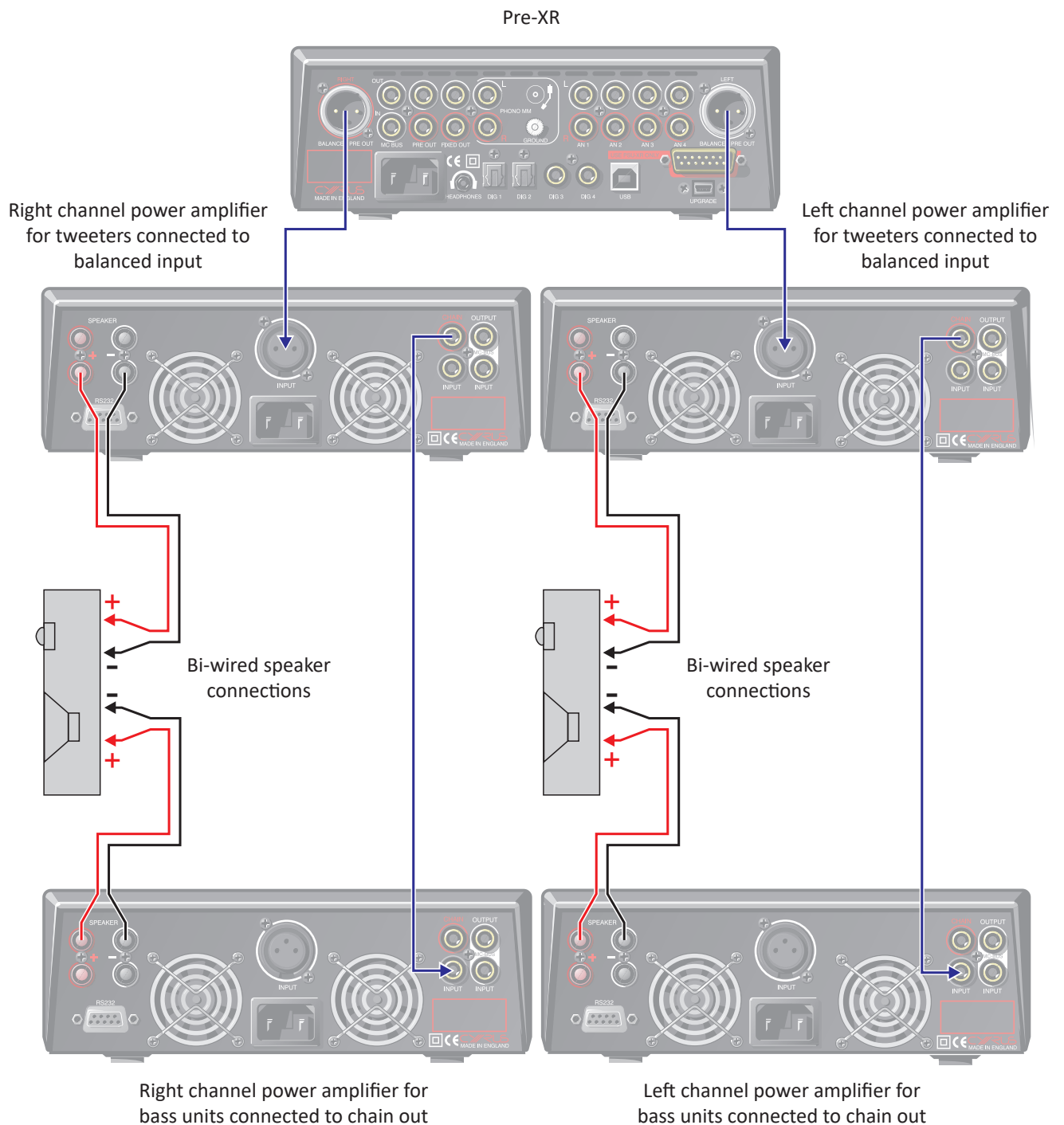

### Using the fixed output of your amplifier

---

The fixed output will feed the sound of the source currently playing at full volume to a tape recorder or a second amplifier in another room.

#### Connecting a tape recorder for recording

- Using a stereo phono interconnect, connect from 'Fixed Out' to the line input or record input of a tape/disc recorder.

*You can now record the source you are playing on the tape/disc recorder.*

#### Connecting a second amplifier

NOTE: Ensure that the second amplifier includes a volume control.

- Using a long stereo phono interconnect, connect 'Fixed Out' to an analogue input of a second amplifier in another room.

*You can now play the same music in both rooms and use the volume controls on the two amplifiers to control the volume in each room separately.*

### Connecting headphones

---

- Connect headphones to the 3.5mm stereo jack socket on the back panel.

*If your headphones have a larger, 6.35mm (1/4") connector an adapter cable can be used. An extension cable (not supplied) may also be used if the headphone cable is not long enough.*

Headphones may be permanently connected to the amplifier and selected when required with the front panel switch.

### Connecting a Cyrus surround sound decoder

---

If your system includes a Cyrus multi-channel surround sound decoder, it may be connected through your stereo amplifier to share the main front speakers of your system.

In this case, connect a stereo phono interconnect from the front channel outputs of the surround decoder to one of the Analogue Inputs of the amplifier. For this system to function correctly both the amplifier and the Cyrus surround decoder must be included in an MC-BUS connection loop and the 'Cyrus AV' Source Type must be set in the menu for the input used (see 'MC-BUS' section and 'Source Type' in the 'Setup menu' section).

When set up in this way, the amplifier will automatically check for the presence of the decoder when the 'Cyrus AV' input is selected, then lock its volume setting to an appropriate level.

### Connecting a surround sound decoder (other brand)

---

If your system includes a multi-channel surround sound decoder (but not a Cyrus model), it may be connected through your amplifier to drive the front channel speakers.

- Connect a stereo phono interconnect from the front channel outputs of the surround decoder to one of the Analogue Inputs of the amplifier.

*For this system to function correctly, the 'AV' input name must be set for the Source Type used (see 'Source Type' in the 'Setup menu' section).*

*When set up in this way, the amplifier will automatically lock its volume setting to a fixed level to match the output of the surround decoder.*

CAUTION: The 'AV' Source Type should only be used for surround decoders that include a volume control, as the volume control of your amplifier will be fixed at a very high level.

## MC-BUS system

Connecting the MC-BUS sockets between components in a Cyrus audio system provides unified system control.

- Connect single phono cables from the MC-BUS output of one unit to the MC-BUS input of another in a daisy-chain as shown in the diagram below.
- Complete the loop by returning the MC-BUS output of the final component to the MC-BUS input of the first.

*With MC-BUS connection established you can control the power function of the entire system from the front panel or remote control.*

*In the system below, selecting 'CD' will switch on the amplifier, the Cyrus power amplifier and a Cyrus CD player. When the amplifier is set to Standby, the entire system will switch off.*

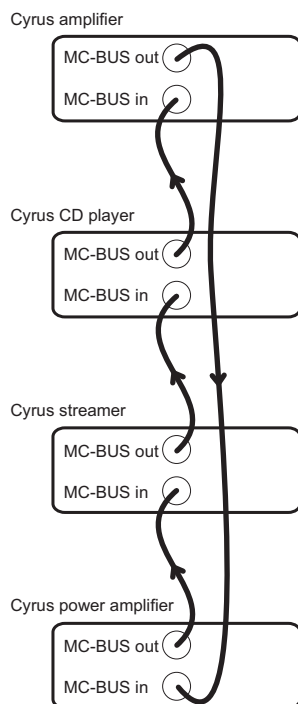

When a Cyrus surround processor is included in the MC-BUS loop, setting of the volume calibration level will take place automatically when the 'Cyrus AV' input is set as 'Source Type'. Refer to the handbook for the surround processor for further details.

## External power supply - PSU-XR

The PSU-XR is a unique DC power supply that will upgrade the sonic performance of compatible products in the Cyrus range.

- To connect a PSU-XR, disconnect both components from the mains.
- Plug the multi-pin interconnect from the PSU-XR into the PSU-XR socket on the back panel.

*CAUTION: Use only the interconnect supplied with the PSU-XR. Other interconnects may damage the PSU-XR and the amplifier.*

- Connect a mains supply to both units.

NOTE: Connection of a PSU-XR is detected automatically, so no internal adjustments are required.

### How it works

The PSU-XR contains five separate power supplies. When a PSU-XR is connected to a Cyrus product, the power from the PSU-XR is applied to specific parts of the connected product.

The twin main power supply of the versatile PSU-XR can be configured to increase the power reserve available for power amplification and servo circuitry or provide ultra-smooth, low noise power for sensitive circuits such as analogue preamplifiers.

Three additional regulated power supplies can be simultaneously applied to other sensitive preamplifier or control circuits as required.

Connection of a PSU-XR will also bring a secondary benefit by significantly reducing the load placed on internal power supplies and therefore reducing any power supply related noise artefacts that may appear within the internal circuitry.

### Connecting to the AC mains supply

Connect the socket on the AC Power cable to the power inlet on the rear panel of the amplifier. Now connect the cable to a suitable AC power point.

NOTE: The means to disconnect this product from the mains supply is the mains plug. Ensure that the mains plug is accessible at all times.

### Operation

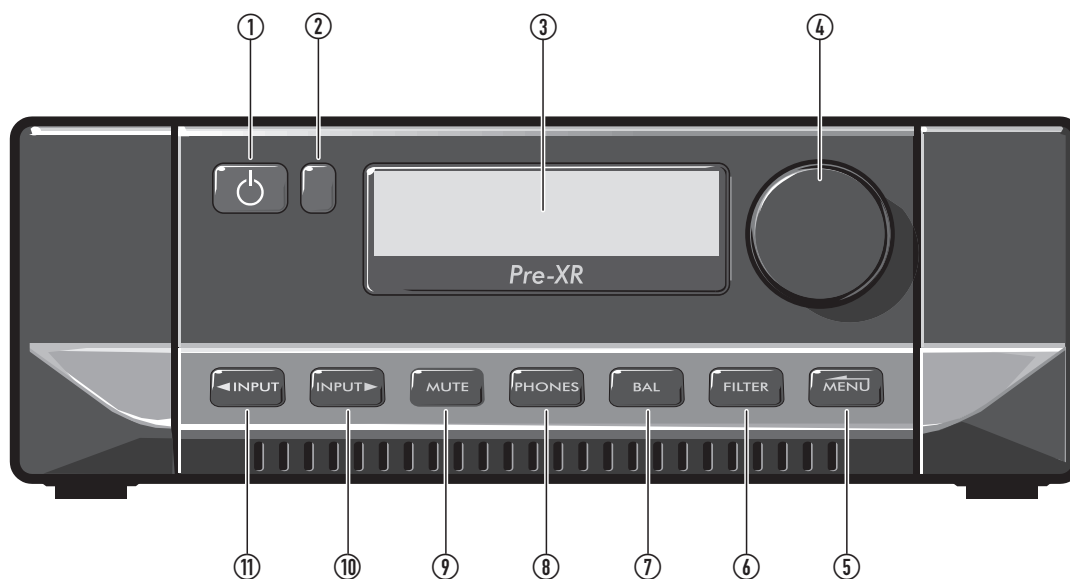

#### Key to the front panel drawing

- |                                   |                    |
|-----------------------------------|--------------------|
| 1. Standby and indicator          | 7. Balance         |
| 2. Remote eye                     | 8. Headphones      |
| 3. Display window                 | 9. Mute            |
| 4. Level control and setup adjust | 10. Next input     |
| 5. Menu                           | 11. Previous input |
| 6. Filter                         |                    |

### Touch pad controls

The front panel controls are touch sensitive. There is no need to press the controls, just lightly touch or hold a finger on the touchpad to select a function.

### Power

#### Mains power

In regular use mains power can be left connected permanently.

When unattended for a long period (holidays etc) mains power should be disconnected.

#### Standby

When mains power is connected, the standby touchpad (1) is used for power control.

- Touch and hold 1 briefly to switch the unit on or set to standby.

*The 1 touchpad will be red when in standby and white when the amplifier is operating.*

When set to standby, all settings in use are retained.

#### Auto-standby

To save energy standby will set automatically 20 minutes after music last played.

### Selecting an input

Inputs may be selected from the front panel touchpads.

- Touch 'INPUT▶' or '◀INPUT'.
- The input names will step through on the display.

### Input source type 'Cyrus AV' or 'AV'

Inputs may have been set as source type 'Cyrus AV' or 'AV'. These source types are for use with surround-sound decoders. When one of these inputs is selected, the amplifier is configured as a power amplifier with fixed gain for the selected input. This enables the surround decoder to share the front left and right speaker channels of a Cyrus stereo system.

*The volume control on the amplifier will be locked at -6dB and mute will be disabled.*

When in one of these AV modes the surround decoder input select and volume controls are used to select a multi-channel source and set the volume level for the system.

To unlock the volume control and return to playing a stereo source, select the input you want to play at the amplifier.

## Playing DSD audio from a computer

Playback of DSD files will require the installation on the computer of a specialist music playback app that supports DSD playback.

- Before playing DSD music, choose, install and configure a DSD player app on a computer connected to the 'USB B' input.
- Select the 'USB' input.
- Play the DSD music file.

## Volume level

The level control performs the dual functions of volume and balance.

### Volume

- Turn the level control to set the volume in 1dB steps.  
*The volume level is shown numerically in dB at the right side of the display.*

### Headphone volume

When headphones are playing, headphone volume level is set and stored separately to speaker volume level. When switching between headphone and speaker operation the last used volume level setting for headphones or speakers will be recalled.

### Safe volume levels after standby

The last used volume level settings for both speakers and headphones are stored when the unit is set to standby. If either or both volume settings are set to an abnormally high level (greater than -30dB) before entering standby, the level will be reduced automatically to a safer level of -30dB for next use.

## Balance

- Touch 'BAL' to change the mode of the front panel level control to set Left/Right channel balance.

*The display will change to show a graphic display of the balance setting.*

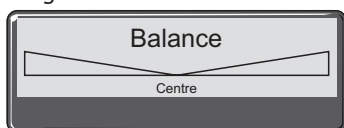

*The default central position is shown in this example.*

- Adjust the channel balance in 1 dB steps by up to 5dB toward the left or right channels by turning the level control.

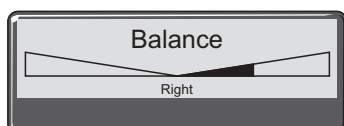

*Balance set 3dB towards the right is shown in this example.*

*After the 5dB setting, one further step will swing the sound balance completely to the left or right speaker. This setting may be useful when checking if the system channels are working correctly etc.*

Balance can also be set by remote control.

## Mute

- Touch 'MUTE' to mute the volume to minimum level without disturbing the existing volume setting.  
*When muted the volume level display will show that the sound is muted.*
- Touch 'MUTE' again to restore the original volume setting.

## Headphones

- Connect your headphones.
  - Touch 'PHONES'.
- The volume level display will switch from 'dB' indication to show a headphone symbol, the sound will mute in the speakers, and switch to the headphones. To return to speaker operation, touch 'PHONES' again.*

Note: Headphones can only be selected when headphones are connected to the rear panel socket.

Warning: Excessive sound pressure from earphones and headphones can cause hearing loss.

## Filter

The Filter function provides the option to select different digital filtering alignments for the internal D/A converter stage. Changing the filter alignment will make subtle changes to the sound of digital sources. The best setting to use will depend on factors such as the sample rate of the recording and the technology used when the recording was made. For that reason, different filter settings may be required to get the best results for different sources, recordings and formats. The default setting provided is chosen for the best all-round performance.

- Touch 'FILTER' repeatedly to step through the available options.

*The filter name will be displayed and the filter setting updated.*

NOTE: The filter setting will not affect the sound of analogue inputs.

The filter setting can also be set by remote control via the settings menu.

**Tape playback and recording**

---

**Playback**

You can play back a recording by selecting the input to which you connected your tape recorder.

**Recording**

If you have connected the 'Fixed Out' sockets to the input of your tape recorder, you can make recordings from the input sources connected to your amplifier.

The recording signal will always track the source that is playing. If the source is changed then the recording source from 'Fixed Out' will also change.

**Playing through a second amplifier**

If you have a second amplifier connected to fixed out, the second amplifier will play the selected source from the main system.

Volume for the second system is controlled by the second amplifier.

NOTE: The fixed output will be muted when the amplifier is muted and during headphone operation.

## Remote control operation

### Remote control introduction

The iR14 remote control will send commands to Cyrus amplifiers, CD players and audio streamers\*.

The remote control can also be programmed with the commands from two other remote control handsets. These will normally be for your TV and a satellite receiver, programmed to the TV and SAT buttons, but could also be other audio components.

\*NOTE: It may be necessary to upgrade the firmware in an audio streamer to enable infra-red remote control operation.

### Remote control backlight

The remote control keypad includes a back-light. The back-light will switch on automatically when moved or when a command is sent.

### Fitting batteries to the remote control

The battery compartment is on the back of the remote control.

1. Press the catch on the battery cover and lift off the cover.
2. Slide a AAA battery under the retaining hook in the upper half of the battery compartment as shown.
3. Fit a second AAA battery into the remaining space.
4. Replace the battery cover.

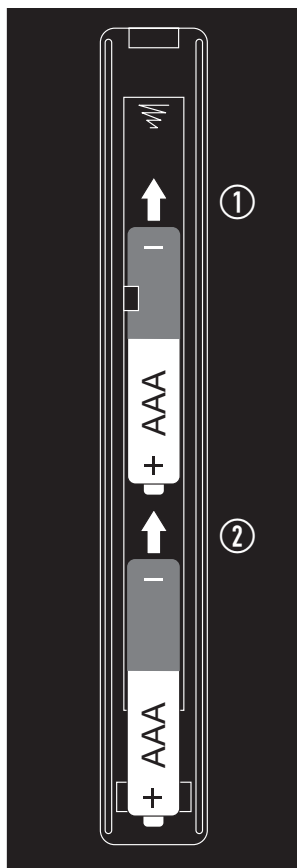

Replace the handset batteries only with AAA batteries of the same voltage and type.

Discard used batteries in accordance with recycling regulations in force in your area.

### Sending commands to Cyrus components

- Press the CYRUS key to switch on a Cyrus amplifier. The remote control will now send commands to a Cyrus amplifier.



### Switching on Cyrus source components

- Press the SOURCE key to switch on a Cyrus CD player and send commands to the CD player and an amplifier.



NOTE: If an amplifier input has been named CD, the amplifier will switch on, set to the correct input.

- Press the MUSIC key to switch on a Cyrus audio streamer and send commands to the streamer and an amplifier.

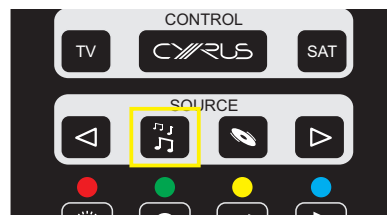

## Cyrus amplifier commands

- Press the CYRUS key to set the remote control to Cyrus amplifier mode.

*You can now control a Cyrus amplifier. The CYRUS key will flash red when commands are being sent in Amplifier mode.*

NOTE: Commands marked \* are for Cyrus XR series amplifiers only, other Cyrus amplifiers will not respond to these commands.

Amplifier mode commands available are listed below –

- Set Cyrus amplifiers, CD players and audio streamers to standby.
- Set the handset to send commands to Cyrus components.
- Send commands to a satellite receiver (or other device programmed to use this key).
- Set the handset to send commands to an amplifier and CD player. Select an input named CD.
- Step to the next amplifier input.
- No command for an amplifier.
- No command for an amplifier.
- Jump to the 'About' menu\*.
- Step up menu options\*.
- Step down menu options\*.
- Step down menu options\*.
- Open menu/select menu option\*.
- Amplifier mute.
- Step to the next amplifier input\*.
- Step to the previous amplifier input\*.
- Open menu/select menu option\*.
- No command for an amplifier.
- No command for an amplifier.
- No command for an amplifier.
- No command for an amplifier.
- No command for an amplifier.
- Setup key for programming TV/SAT keys.
- No command for an amplifier.
- No command for an amplifier.
- No command for an amplifier.
- No command for an amplifier.
- No command for an amplifier.
- No command for an amplifier.
- No command for an amplifier.
- Volume down.
- Volume up.
- Balance.
- Step back in menu tree\*.
- Step up menu options\*.
- Open menu/select menu option\*.
- Menu home page\*.

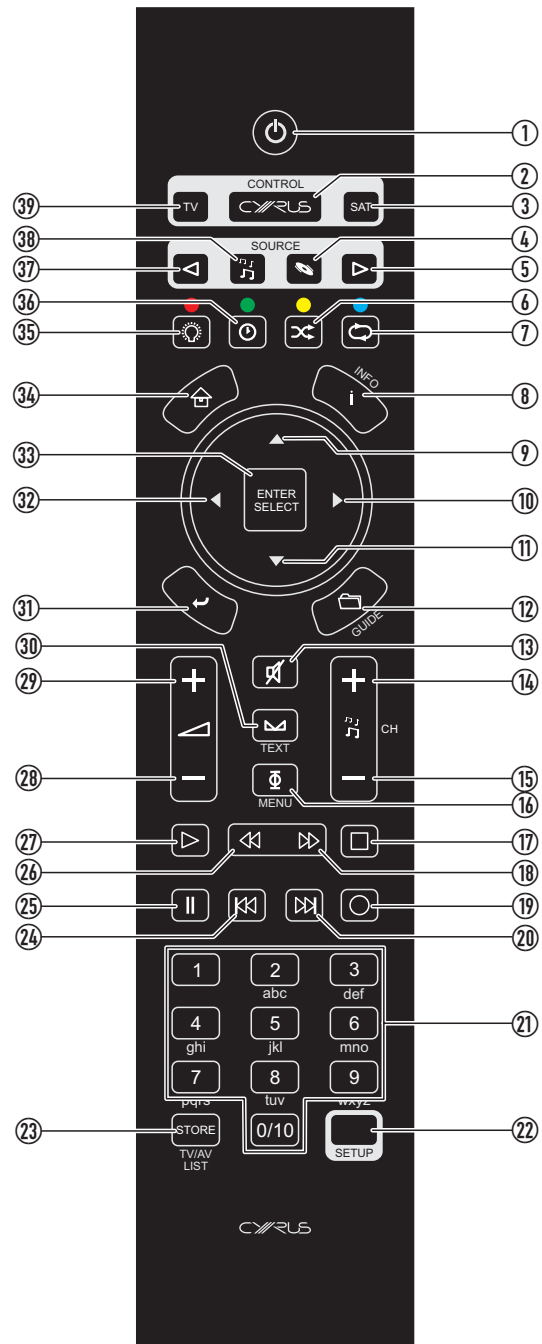

- Display off.
- No command for an amplifier.
- Step to the previous input.
- Set the handset to send commands to an amplifier and audio streamer.
- Send commands to a TV (or other device programmed to use this key).



## Cyrus CD player commands

- Press the CYRUS key
- Press the  key to set the remote control to CD mode.

The key will light red. You can now control both a Cyrus CD player and amplifier. The  key will flash red when commands are being sent in CD mode.

NOTE: Commands marked \* are for Cyrus XR series CD players only, other Cyrus CD players will not respond to these commands.

The CD mode commands available are listed below –

1. Set Cyrus amplifiers, CD players and audio streamers to Standby.
2. Set the handset to send commands to an amplifier.
3. Send commands to a satellite receiver (or other device programmed to use this key).
4. Set the handset to send commands to an amplifier and CD player. Select an input named CD.
5. Step to the next amplifier input.
6. No command for a CD player.
7. CD player repeat.
8. Jump to the 'About' menu\*.
9. CD player next track/step up menu options\*.
10. CD player search forwards/step down menu options\*.
11. CD player previous track/step down menu options\*.
12. Open menu/select menu option\*.
13. Amplifier mute.
14. No command for a CD player.
15. No command for a CD player.
16. CD player audio phase.

*Changes in phase are subtle and are best established from the listening position. When the phase setting is changed, the display text area will show the message 'Phase Normal' or 'Phase Invert'. The performance of the CD player is unaffected whether the signal is in normal or phase inverted mode.*

17. CD player stop.
18. CD player search forwards.
19. No command for a CD player.
20. CD player next track.
21. CD player numeric keypad.
22. Setup key for programming TV/SAT keys.
23. CD player memory store.
24. CD player previous track.
25. CD player pause.
26. CD player search back.
27. CD player play/pause.
28. Amplifier volume down.
29. Amplifier volume up.

*Enter a one or two digit track number to jump to a specific track.*

22. Setup key for programming TV/SAT keys.
23. CD player memory store.
24. CD player previous track.
25. CD player pause.
26. CD player search back.
27. CD player play/pause.
28. Amplifier volume down.
29. Amplifier volume up.

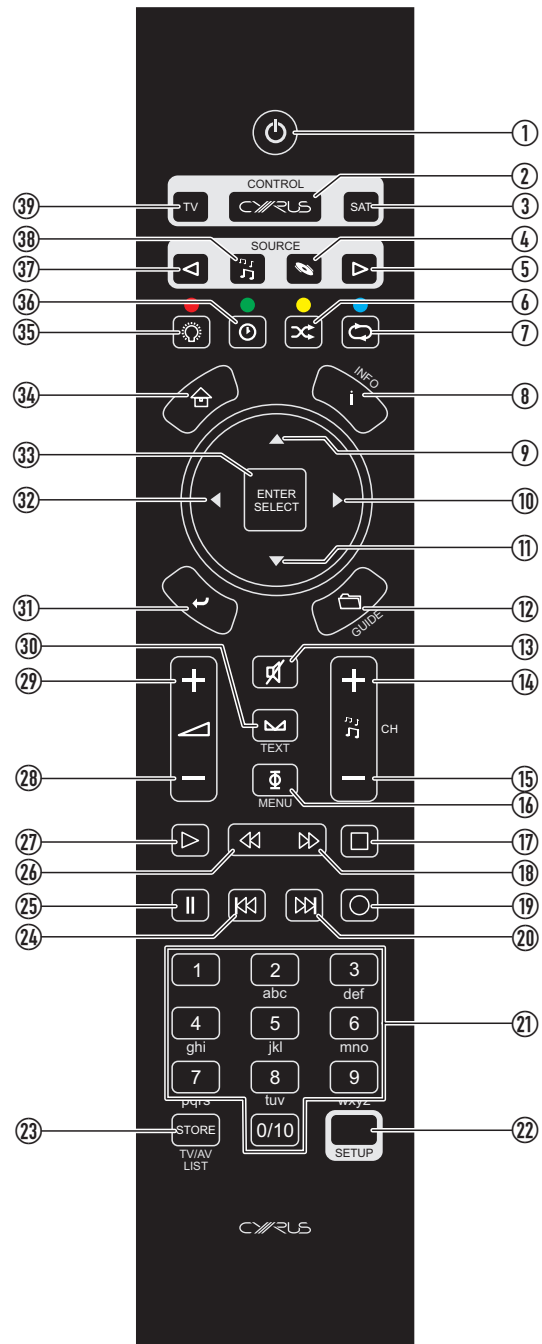

30. Amplifier balance.
31. Step back in menu tree\*.
32. Step up menu options\*.
33. No command for a CD player.
34. Menu home page\*.
35. CD player display off.
36. CD player display mode.  
*Choose track elapsed time or disc remaining time.*
37. Step to the previous amplifier input.
38. Set the handset to send commands to an amplifier and Audio streamer.
39. Send commands to a TV (or other device programmed to use this key).

**Cyrus audio streamer commands**

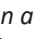
- Press the CYRUS key
- Press the  key to set the remote control to audio streamer mode.  
*The key will light red. You can now control both a Cyrus audio streamer and amplifier or an audio streamer that includes an amplifier. The  key will flash red when commands are being sent in audio streamer mode.*

The audio streamer mode commands available are listed below –

1. Set Cyrus amplifiers, CD players and audio streamers to Standby.
2. Set the handset to send commands to a Cyrus amplifier.
3. Send commands to a satellite receiver (or other device programmed to use this key).
4. Set the handset to send commands to an amplifier and CD player. Select an input named CD.
5. Step to the next amplifier input.
6. No command for an audio streamer.
7. Audio streamer repeat.
8. Audio streamer display information.
9. Audio streamer cursor up.
10. Audio streamer cursor right.
11. Audio streamer cursor down.
12. No command for an audio streamer.
13. Amplifier mute.
14. No command for an audio streamer.
15. No command for an audio streamer.
16. No command for an audio streamer.
17. Audio streamer stop.
18. No command for an audio streamer.
19. No command for an audio streamer.
20. Audio streamer next track.
21. Audio streamer alpha-numeric keypad.
22. Setup key for programming TV/SAT keys.
23. No command for an audio streamer.
24. Audio streamer previous track.
25. Audio streamer pause.
26. No command for an audio streamer.
27. Audio streamer play/pause.
28. Amplifier volume down.
29. Amplifier volume up.
30. Amplifier balance.
31. Audio streamer back.
32. Audio streamer cursor left.
33. Audio streamer select.
34. Audio streamer home.
35. Audio streamer display off.
36. No command for an audio streamer.
37. Step to the previous amplifier input.

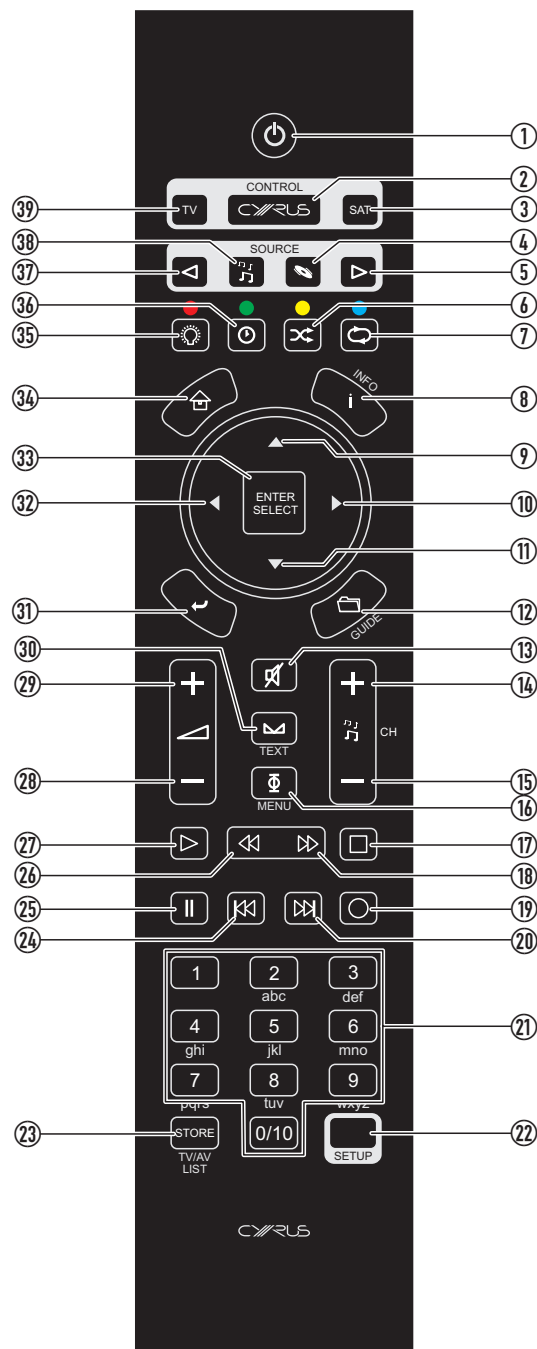

38. Set the handset to send commands to an amplifier and audio streamer.
39. Send commands to a TV (or other device programmed to use this key).

**Cyrus Phono Signature commands**

Commands are sent to the Phono Signature via keys reserved from the amplifier control system.

The remote control operates in the same way as the front panel controls - press a key to select a function, change that setting with the 'CURSOR' keys, confirm the setting with 'ENTER/SELECT'.

This page lists commands that will control the Phono Signature.

- Press the CYRUS key to set the remote control to Cyrus mode.

You can now control both a Cyrus amplifier and the Phono Signature. The CYRUS key will flash red when commands are being sent in this mode.

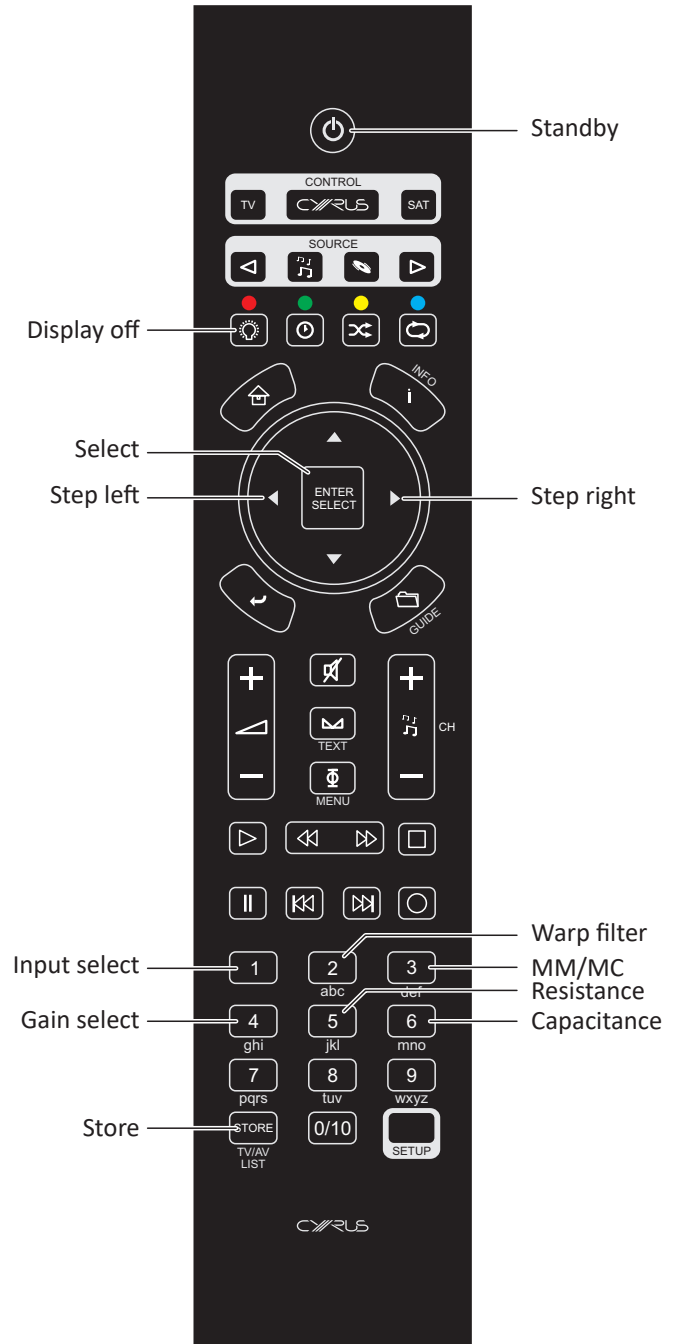

## Setup menus

Setup menus enable extensive customisation of the user interface.

### Setup options

The next two pages show a map of the menu options available.



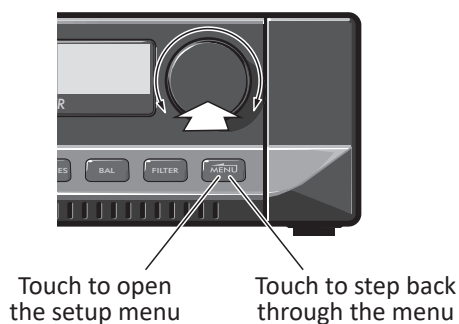

### Navigating the menu from the front panel

- Touch **MENU** to open the settings menu.
- Turn the rotary control to step through the available options.
- Press the rotary control to select an option.
- Touch **MENU** to step back through the menu without making any changes.

Turn to step through menu options, push to select an option



### Navigating the menu from the remote control

- Press  to open the menu home page.
- Press  or  to step through the available options.
- Press  to select an option.
- Press  to step back through the menu without making any changes.

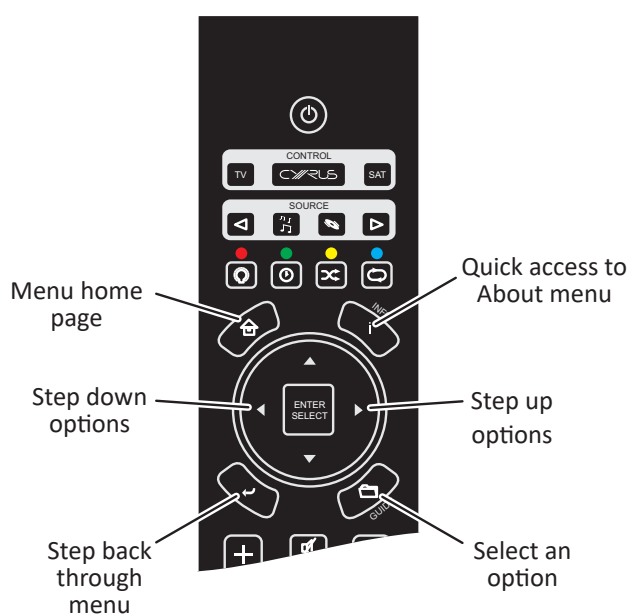

## Menu maps

### Setup

#### → General

##### → Default Input

###### ↳ Select an input from the list

*Sets the default input that will select whenever the amplifier is connected to mains power.*

*NOTE: When exiting standby the amplifier will re-select the last-used input, not the default.*

##### → Headphones

###### → Auto Select

*The amplifier will switch between headphone and speaker operation when headphones are connected/unplugged.*

*If headphones are permanently connected it is still possible to switch between headphone and speaker operation manually by touching 'PHONES' on the front panel.*

###### → Manual

*Headphone operation can only be selected manually. Switch between headphone and speaker operation by touching 'PHONES' on the front panel.*

##### → Balance

*Enables left/right channel balance adjustment. This is the same function that is available via the quick-access balance adjust keys on the front panel and remote control. Refer to the 'Balance' section for more detail.*

##### → Standby Sensitivity

*The sensitivity of the front panel touchpads is adjustable to compensate for changes in the local environment.*

*'Low', 'Medium' and 'High' settings are available. The default 'Medium' setting is normally suitable for most systems. Setting to 'High' will increase touchpad sensitivity if these are unresponsive or 'Low' if there are occasional false responses. After setting the sensitivity, operate the standby touchpad once to complete the setup.*

*NOTE: It is necessary to hold the standby touchpad briefly to operate it.*

##### → DAC Filter

*Enables selection of different digital filter options for the DAC stage. This is the same function that is available via the quick-access 'FILTER' touchpad on the front panel. Refer to the 'Filter' section for more detail.*

### → Input

#### ↳ Select an input to configure

##### → Source Type

*Change the source type of the selected input. Setting this option will determine how the selected input will respond to MC-BUS commands. For example, if an input source type is set to 'Streamer', and the system is cabled for MC-BUS control, a connected Cyrus streamer will switch on when that input is selected. Choose 'Unspecified' to disable MC-BUS from the selected input.*

*NOTE: The source type selected will not change the name of the input. The input name can be changed separately via the Name menu option.*

##### → Name

*Change the name of the selected input. Choose a name from the list provided.*

*NOTE: The name chosen will not change the MC-BUS response of the selected input. The MC-BUS response can be changed separately via the 'Source Type' menu option.*

##### → Volume Offset

*Change the volume offset for the selected input. Whilst digital inputs will generally play at equal volumes, analogue inputs will play at different volumes, depending on the output of the source. Volume offset is an option that can equalise the volume of all the connected sources by reducing the volume level for louder sources or increasing the volume of quieter sources.*

##### → Max Vol

*The 'Max Vol' option enables a volume limit to be set for the selected input when listening via speakers. Once set, the volume control cannot be increased beyond the set limit. To limit the volume setting available from all inputs, each will need to be set individually.*

##### → Max HP Vol

*The 'Max HP Vol' option enables a volume limit to be set for the selected input when listening via headphones. Once set, the volume control cannot be increased beyond the set limit. To limit the volume setting available from all inputs, each will need to be set individually.*

→ Aesthetic - - - -> See the next page for 'Aesthetic' menu options

→ System - - - -> See the next page for 'System' menu options

## Menu maps

---

### Setup

- General --> See the previous page for 'General' menu options
- Input ----> See the previous page for 'Input' menu options
- Aesthetic
  - Display Polarity  
*Sets the display polarity to positive (dark characters on a light background) or negative (light characters on a dark background).*
  - Display Contrast  
*Sets the contrast of the display in the range -30 to +30. Factory default setting is -4.*
  - Display Brightness  
*Sets the brightness of the display in the range Level 1 to Level 5. Factory default setting is Level 5.*
  - LED brightness  
*Sets the brightness of the standby indicator in the range Level 1 to Level 5. Factory default setting is Level 5.*
- System
  - Language
    - ↳ Select an language from the list  
*This option changes the language for the display.*  
*NOTE: Avoid changing the language to a language you can't read. It will be difficult to reset to your local language if you can't read the display.*
  - Factory Reset  
*This option will return all user settings to the factory defaults. After selecting this option you will need to confirm you want to go ahead by selecting 'Yes' from the sub-menu. Factory reset cannot be undone.*
  - About  
*This option displays information about the firmware of the unit including model name, firmware version and release date.*

**Firmware updates**

---

The operational firmware may be upgraded from time to time to add new features and to fix operational issues.

New firmware versions will be available from the 'Support' pages of the Cyrus website [www.cyrusaudio.com](http://www.cyrusaudio.com).

If new firmware is available, this will be packaged with other documents including -

- Firmware version change log.
- Latest firmware update procedure.
- Revised handbook (if required).

### Remote control learning

In addition to controlling Cyrus components, the remote control can learn the commands from two other remote control handsets. These will normally be a TV and a satellite or terrestrial TV receiver, programmed to the 'TV' and 'SAT' buttons, but could also be other audio components.

All keys may be programmed with the exception of the groups marked 'CONTROL' and 'SOURCE' and the 'SETUP' key.

#### Preparation for learning

Check the following points before attempting to learn any commands -

- Check that both remote controls have fresh batteries.
- Choose a location on a tabletop that is not brightly lit. Subdued light is better, away from bright natural or indoor lighting.
- Check that you have enough time to spare to complete the learning process for all the keys you want to use.

#### Learning commands

In this example, the Cyrus remote control will be learning commands from a 'reference' satellite receiver remote control.

1. Set the two remote controls up facing each other, spaced by about 5cm.

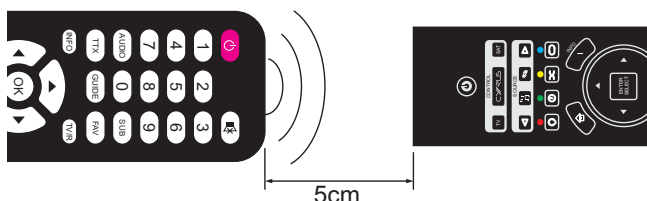

2. Press the 'TV' or 'SAT' key to select the mode that you want to program.

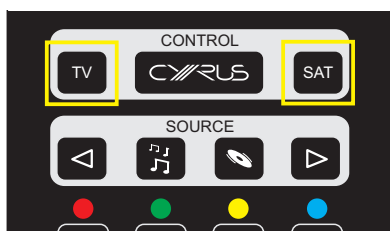

The keypad will light and the key you selected will be red.

3. Press and hold the 'SETUP' key.



The mode key will change to white. After about three seconds, the mode key will light red again. This indicates that the remote control is ready to learn codes.

4. Release the 'SETUP' key.
 

The remote control is now waiting to learn commands. The keypad will light continually and the mode key will light pale red.
5. On the reference remote control, press and hold the first key you want to learn (for example, volume up) until the mode key flashes red.
 

This indicates that the command has been received.
6. Release the key on the reference remote control.
7. Press a key on the Cyrus remote control (volume up in this example) to select where you want to save that command.
 

The mode key will stop flashing. This indicates that the command has been saved successfully. If the learning process was successful, the remote control will be ready to learn the next command.
8. Repeat steps 5 to 7 for each command you want to learn.

When you have completed learning all commands -

- Press the 'SETUP' key.
 

The mode key will change to white. After a few seconds the backlight will switch off.



### **Checking programmed commands**

---

- Select the mode that you just programmed and check that the commands were learned successfully.

NOTE: The 'TV' or 'SAT' mode key should flash red when sending a command. If the mode key is not flashing, then the command has not learned correctly.

- Make a note of any commands that have not programmed correctly and repeat the learning process to add these in.

NOTE: When you start the learning process it does not erase any programmed keys so you can re-program individual keys if required.

### **Problems with learning**

---

If none of the commands have learned correctly, try re-starting the learning process again. Test a few keys first to ensure that your handset is compatible for learning. If the test works then continue to program the rest of the commands you need.

If you still have problems, check carefully that the mode light is flashing correctly as you send a command to learn. If not, it may be that the batteries need replacement in the reference handset or that the spacing between the handsets is not ideal. Try adjusting the spacing between the handsets and repeating the learning process.

If you continue to have problems, it may be that your handset is incompatible with the learning process. This could happen with an older design of handset or one that has an unusual code-set.

### **Sending TV or SAT commands**

---

Once you have programmed all the keys with the commands you want, you can use the remote control to send commands to your TV or Satellite receiver etc.

- Press the 'TV' or 'SAT' key to select the mode you want.
- Press the command key.

The mode key will flash red when sending a programmed command.

## Troubleshooting guide

If your amplifier is not operating properly, disconnect the power and check carefully all connections.

If you are in any doubt, consult your retailer.

<b>No sound</b>	
The amplifier (or power amplifiers) is switched off or in standby.	Bring the unit(s) out of standby. (standby indicator - WHITE)
Mute is on	Deselect mute
The source is not working (e.g. CD not playing or paused).	Check the source.
<b>No sound (digital sources)</b>	
The sample rate or sound format of the digital signal from the source may not be correct.	Check that the sample rate from the source is within the specification of the amplifier and that the program is encoded as two channel stereo.
<b>No sound from one loudspeaker</b>	
Balance control at extreme limit.	Centralise balance.
Does your speaker have fuses?	Check speaker, replace fuses.
Speaker cables / interconnects faulty.	Check connections, cables - replace if needed.
<b>Spurious noises from speakers</b>	
Interconnects or connections faulty.	Check, replace where necessary.
<b>Standby is activated randomly</b>	
Auto standby may have operated.	To save energy, the unit will automatically set to standby if no music plays for 20 minutes.
The touchpads may need calibrating.	Manually operate the Standby touchpad from the front panel to calibrate the touch pads. Calibration is always advisable if the unit has recently been disconnected from the mains.
The sensitivity of the touchpads may need changing.	The sensitivity of the touchpads can be adjusted in the setup menu.
<b>Remote control not operating</b>	
The batteries may be flat.	Check the batteries.
<b>Remote control lights flash</b>	
This indicates that the batteries are flat.	Replace the batteries.

## Error indication

Your amplifier has a unique error indication system to help you to diagnose problems. If an error is detected in use, the display will show 'Error' with indication of the type of error as shown in the table.

<b>Mains</b>	
The mains supply voltage has been outside of safe limits.	Disconnect the amplifier from mains power and re-connect it. If the fault persists arrange for an electrician to check the mains supply voltage.
<b>Internal PSU fault</b>	
This fault condition will be displayed if there is a fault with the internal power supply of the amplifier.	A PSU fault cannot be corrected by the user. The amplifier should be returned to your retailer.
<b>External PSU fault</b>	
This fault condition will be displayed if there is a fault with a connected PSU-XR.	Disconnect the amplifier and PSU-XR from mains power. Check the interconnect between the two units, then re-connect to the mains. If the fault persists the PSU-XR should be returned to your retailer.

If a fault condition still remains, return the amplifier to your Cyrus appointed retailer or an authorised Service Centre.

**Specifications**

**Power Supply**

Voltage: ..... As plate on rear of unit

**Power Consumption**

Standby..... <0.5W

Maximum ..... 10W

EMC & Safety Compliance..... CE

**Enclosure**

Dimensions (WxHxD)..... 215 x 75 x 365mm

Weight ..... 4.0kg

Material..... Die cast chassis

**Analogue audio performance**

Input Sensitivity..... 500mV

Input Impedance ..... 40kΩ

Frequency Response (-3dB)..... 0.1Hz, >500kHz

Signal to Noise Ratio (unWTD) .....108dB

THD+N, 1kHz ..... <0.002%

Output voltage (unbalanced) .....1V

Output voltage (balanced).....2V

Max output voltage (unbalanced) .....2.5V

Max output voltage (balanced) .....5V

Output impedance (unbalanced) ..... 47Ω

Output impedance (balanced) ..... 47Ω

**Digital audio performance**

Input voltage .....500mV pk-pk

Input Impedance ..... 75Ω

Sample rate range (SPDIF) ..... 22.05k - 192k

Sample rate range (USB)..... 44.1k - 768k

Audio formats (SPDIF) ..... PCM stereo

Audio formats (USB)..... DSD64, DSD128, DSD256, DSD512

DoP, PCM

S/N ratio (Pre-out, 0dB FS) ..... >113dBA

THD (Pre-out, 0dB FS)..... <0.001%

Cyrus reserves the right to change all specifications without notice. E &OE

**Warranty**

The warranty period is two years. No retailer or distributor may vary the terms of this warranty, which is personal to the original purchaser and is not transferable.

Please retain the sales receipt as proof of purchase.

Warranty claims must wherever possible be made through the retailer from whom the equipment was purchased.

This warranty excludes:

- Damage caused through neglect, accident, misuse, wear and tear, or through incorrect installation, adjustment or repair by unauthorised personnel. Any unauthorised servicing will result in loss of warranty.
- Liability for damage or loss occurring in transit to or from the purchaser.
- Consequential damage, loss or injury, arising from or in conjunction with this equipment.

Equipment for attention under warranty should be consigned return carriage paid. If returned equipment is found to comply with the published specification, CYRUS reserves the right to raise a charge.

The above conditions do not affect your statutory rights as a consumer.

**WEEE**

This logo means that this product is not to be disposed of with your household waste. This product should be handed over to a designated collection point to be recycled. Your cooperation in the correct disposal of this product will contribute to the effective usage of natural resources. For more information on collection points, contact your local government for more information about recycling.





Cyrus Audio Ltd., Ermine Business Park, Huntingdon, PE29 6XY, U.K.